

## British Standard Pipe Parallel (BSPPOR) Connection Types / Identification

This series (G) contains BSPP Parallel Port Connectors with a washer / o-ring seal included. For a more complete series of BSPP adapters, most all males in series "B" can be used for as a Port Connection with the addition of a bonded seal.

### Measurement Procedure

1. With calipers, measure the O.D. (outer diameter) of the Male threads or the I.D. (inner diameter) of the Female threads.
2. Check the thread pitch with the thread pitch gauges.
3. Compare measurements against chart.

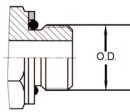

**BSPP Port Connection Male**  
(Washer & O-Ring)

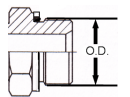

**BSPP Port Connection Male**  
(Bonded Seal)

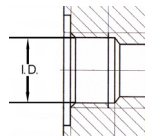

**BSPP Female Port**

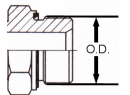

**BSPP Port Connection Male**  
(Captive Seal)

Dash Size	Nominal Size	Thread Pitch	Male Thread O.D. (Inches)		Female Thread I.D. (Inches)	
2	1/8	28	.375	3/8	.344	11/32
4	1/4	19	.531	17/32	.469	7/16
6	3/8	19	.656	21/32	.594	19/32
8	1/2	14	.813	13/16	.750	3/4
12	3/4	14	1.031	1 1/32	.969	15/16
16	1	11	1.938	1 15/16	1.219	1 13/16
20	1 1/4	11	1.656	1 21/32	1.531	1 17/32
24	1 1/2	11	1.875	1 7/8	1.781	1 25/32

### Contents of page series **G**

<b>BSPPOR</b> (Port Connection O-Ring / Washer).....	<b>G1</b>
<i>Converted to</i> ..... ○ BSPP.....	<b>G2</b>
<i>Converted to</i> ..... ○ NPT.....	<b>G3</b>
<i>Converted to</i> ..... ○ JIC.....	<b>G4</b>
<i>Converted to</i> ..... ○ ORFS.....	<b>G6</b>

## BSPP Port Plug (Allen Type with Captive Seal)



Part Number	BSPPOR	List \$
<b>0PHG-02WD</b>	1/8-28	<b>2.07</b>
<b>0PHG-04WD</b>	1/4-19	<b>3.11</b>
<b>0PHG-06WD</b>	3/8-19	<b>3.76</b>
<b>0PHG-08WD</b>	1/2-14	<b>5.74</b>
<b>0PHG-12WD</b>	3/4-14	<b>8.37</b>
<b>0PHG-16WD</b>	1-11	<b>16.00</b>
<b>0PHG-20WD</b>	1¼-11	<b>28.69</b>
<b>0PHG-24WD</b>	1½-11	<b>41.47</b>

Captive seal is Nitrile (Buna N), for Viton Seal add "-V" at the end of the part number.  
Example : 0PHG-08WD-V  
Prices for Viton option quoted upon request.

## BSPP Male to BSPPOR Male (Washer / O-Ring)

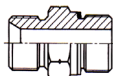

This series quoted upon request.  
See 10BB nipple with BBS bonded seal or 10BB-WD (pg. B2 & B3) for equivalent.

Part Number	BSPP	BSPPOR
<b>10BG-02-02</b>	1/8-28	1/8-28
<b>10BG-04-04</b>	1/4-19	1/4-19
<b>10BG-04-06</b>	1/4-19	3/8-19
<b>10BG-06-04</b>	3/8-19	1/4-19
<b>10BG-06-06</b>	3/8-19	3/8-19
<b>10BG-08-08</b>	1/2-14	1/2-14
<b>10BG-08-12</b>	1/2-14	3/4-14
<b>10BG-10-08</b>	5/8-14	1/2-14
<b>10BG-12-08</b>	3/4-14	1/2-14
<b>10BG-12-12</b>	3/4-14	3/4-14
<b>10BG-16-08</b>	1-11	1/2-14
<b>10BG-16-12</b>	1-11	3/4-14
<b>10BG-16-16</b>	1-11	1-11
<b>10BG-20-20</b>	1¼-11	1¼-11
<b>10BG-24-24</b>	1-11½	1-11½

## BSPP Male to BSPPOR Male Adjustable 45° Elbow (Nut / Washer / O-Ring)



Part Number	BSPP	BSPPOR
<b>14BG-04-04</b>	1/4-19	1/4-19
<b>14BG-04-06</b>	1/4-19	1/4-19
<b>14BG-04-08</b>	1/4-19	3/8-19
<b>14BG-06-06</b>	3/8-19	3/8-19
<b>14BG-06-08</b>	3/8-19	1/2-14
<b>14BG-08-08</b>	1/2-14	1/2-14
<b>14BG-12-12</b>	3/4-14	3/4-14
<b>14BG-12-16</b>	3/4-14	1-11
<b>14BG-16-16</b>	1-11	1-11
<b>14BG-20-20</b>	1¼-11	1¼-11
<b>14BG-24-24</b>	1-11½	1-11½

## BSPP Male to BSPPOR Male Adjustable 90° Elbow (Nut / Washer / O-Ring)



Part Number	BSPP	BSPPOR
<b>19BG-04-04</b>	1/4-19	1/4-19
<b>19BG-04-06</b>	1/4-19	3/8-19
<b>19BG-04-08</b>	1/4-19	1/2-14
<b>19BG-06-04</b>	3/8-19	1/4-19
<b>19BG-06-06</b>	3/8-19	3/8-19
<b>19BG-06-08</b>	3/8-19	1/2-14
<b>19BG-08-08</b>	1/2-14	1/2-14
<b>19BG-12-08</b>	3/4-14	1/2-14
<b>19BG-12-12</b>	3/4-14	3/4-14
<b>19BG-12-16</b>	3/4-14	1-11
<b>19BG-16-16</b>	1-11	1-11
<b>19BG-20-20</b>	1¼-11	1¼-11
<b>19BG-24-24</b>	1-11½	1-11½

For BSPP thread charts, see page B1

## BSPP Male to BSPPOR Male Adjustable Run Tee (Nut / Washer / O-Ring)



Part Number	BSPP	BSPP	BOR
<b>ABBG-04-04-04</b>	1/4-19	1/4-19	1/4-19
<b>ABBG-06-06-04</b>	3/8-19	3/8-19	1/4-19
<b>ABBG-06-06-06</b>	3/8-19	3/8-19	3/8-19
<b>ABBG-08-08-06</b>	1/2-14	1/2-14	3/8-19
<b>ABBG-08-08-08</b>	1/2-14	1/2-14	1/2-14
<b>ABBG-12-12-08</b>	3/4-14	3/4-14	1/2-14
<b>ABBG-12-12-12</b>	3/4-14	3/4-14	3/4-14
<b>ABBG-16-16-12</b>	1-11	1-11	3/4-14
<b>ABBG-16-16-16</b>	1-11	1-11	1-11

## BSPP Male to BSPPOR Male Adjustable Run Tee (Nut / Washer / O-Ring)



Part Number	BSPP	BOR	BSPP
<b>ABGB-04-04-04</b>	1/4-19	1/4-19	1/4-19
<b>ABGB-06-06-06</b>	3/8-19	3/8-19	3/8-19
<b>ABGB-08-08-08</b>	1/2-14	1/2-14	1/2-14
<b>ABGB-12-12-12</b>	3/4-14	3/4-14	3/4-14
<b>ABGB-16-16-16</b>	1-11	1-11	1-11

## BSPPOR Male to BSPP Female Swivel

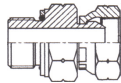

*This series quoted upon request.  
See 20BB + BBS Bonded Seal for equivalent.*

Part Number	BSPPOR	BSPP
20GB-02-02	1/8-28	1/8-28
20GB-04-02	1/4-19	1/8-28
20GB-04-04	1/4-19	1/4-19
20GB-04-06	1/4-19	3/8-19
20GB-06-04	3/8-19	1/4-19
20GB-06-06	3/8-19	3/8-19
20GB-06-08	3/8-19	1/2-14
20GB-08-06	1/2-14	3/8-19
20GB-08-08	1/2-14	1/2-14
20GB-08-10	1/2-14	5/8-14
20GB-08-12	1/2-14	3/4-14
20GB-12-08	3/4-14	1/2-14
20GB-12-12	3/4-14	3/4-14
20GB-12-16	3/4-14	1-11
20GB-16-12	1-11	3/4-14
20GB-16-16	1-11	1-11
20GB-20-16	1 1/4-11	1-11
20GB-20-20	1 1/4-11	1 1/4-11
20GB-24-24	1 1/2-11	1 1/2-11

## BSPPOR Male to Female BSPP Solid (Washer / O-Ring)



*This series quoted upon request  
See 50BB + BBS Bonded Seal for equivalent*

Part Number	BSPPOR	BSPP
50GB-04-04	1/4-19	1/4-19
50GB-04-06	1/4-19	3/8-19
50GB-04-08	1/4-19	1/2-14
50GB-06-04	3/8-19	1/4-19
50GB-06-06	3/8-19	3/8-19
50GB-06-08	3/8-19	1/2-14
50GB-08-06	1/2-14	3/8-19
50GB-08-08	1/2-14	1/2-14
50GB-08-12	1/2-14	3/4-14
50GB-12-08	3/4-14	1/2-14
50GB-12-12	3/4-14	3/4-14
50GB-12-16	3/4-14	1-11

*50GB series continued on next column*

50GB series continued from last column

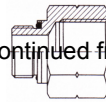

*This series quoted upon request.*

Part Number	BSPPOR	BSPP
50GB-16-12	1-11	3/4-14
50GB-16-16	1-11	1-11
50GB-16-20	1-11	1 1/4-11
50GB-20-24	1 1/4-11	1 1/2-11

## BSPPOR Male to BSPP Female Solid Adjustable 90° Elbow

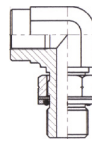

*This series quoted upon request.*

Part Number	BSPPOR	BSPP
59GB-02-02	1/8-28	1/8-28
59GB-04-04	1/4-19	1/4-19
59GB-04-06	1/4-19	3/8-19
59GB-06-06	3/8-19	3/8-19
59GB-06-08	3/8-19	1/2-14
59GB-08-08	1/2-14	1/2-14
59GB-12-08	3/4-14	1/2-14
59GB-12-12	3/4-14	3/4-14
59GB-12-16	3/4-14	1-11
59GB-16-16	1-11	1-11
59GB-20-20	1 1/4-11	1 1/4-11

## BSPPOR Male to NPT Female Solid

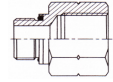

Part Number	BSPPOR	NPT
50GN-02-02	1/8-28	1/8-27
50GN-02-04	1/8-28	1/4-18
50GN-04-02	1/4-19	1/8-27
50GN-04-04	1/4-19	1/4-18
50GN-06-02	3/8-19	1/8-27
50GN-06-04	3/8-19	1/4-18
50GN-06-06	3/8-19	3/8-18
50GN-06-08	3/8-19	1/2-14
50GN-08-04	1/2-14	1/4-18
50GN-08-06	1/2-14	3/8-18
50GN-08-08	1/2-14	1/2-14
50GN-08-12	1/2-14	3/4-14
50GN-12-04	3/4-14	1/4-18
50GN-12-06	3/4-14	3/8-18
50GN-12-08	3/4-14	1/2-14
50GN-12-12	3/4-14	3/4-14
50GN-16-04	1-11	1/4-18
50GN-16-06	1-11	3/8-18
50GN-16-08	1-11	1/2-14
50GN-16-12	1-11	3/4-14
50GN-16-16	1-11	1-11 1/2
50GN-16-20	1-11	1 1/4-11 1/2
50GN-16-24	1-11	1 1/2-11 1/2
50GN-20-12	1 1/4-11	3/4-14
50GN-20-16	1 1/4-11	1-11 1/2
50GN-20-20	1 1/4-11	1 1/4-11 1/2
50GN-24-16	1 1/2-11	1-11 1/2
50GN-24-20	1 1/2-11	1 1/4-11 1/2
50GN-24-24	1 1/2-11	1 1/2-11 1/2
50GN-32-32	2-11	2-11 1/2

## JIC Male to BSPPOR Male (Washer / O-Ring)

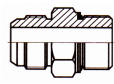

Part Number	JIC	BSPPOR
10JG-04-02	7/16-20	1/8-28
10JG-04-04	7/16-20	1/4-19
10JG-04-06	7/16-20	3/8-19
10JG-04-08	7/16-20	1/2-14
10JG-05-02	1/2-20	1/8-28
10JG-05-04	1/2-20	1/4-19
10JG-05-06	1/2-20	3/8-19
10JG-05-08	1/2-20	3/4-16
10JG-05-12	1/2-20	1 1/16-12
10JG-06-02	9/16-18	1/8-28
10JG-06-04	9/16-18	1/4-19
10JG-06-06	9/16-18	3/8-19
10JG-06-08	9/16-18	1/2-14
10JG-08-04	3/4-16	1/4-19
10JG-08-06	3/4-16	3/8-19
10JG-08-08	3/4-16	1/2-14
10JG-08-12	3/4-16	3/4-14
10JG-10-06	7/8-14	3/8-19
10JG-10-08	7/8-14	1/2-14
10JG-10-12	7/8-14	3/4-14
10JG-10-16	7/8-14	1-11
10JG-12-06	1 1/16-12	3/8-19
10JG-12-08	1 1/16-12	1/2-14
10JG-12-12	1 1/16-12	3/4-14
10JG-12-16	1 1/16-12	1-11
10JG-12-20	1 1/16-12	1 1/4-11
10JG-16-12	1 5/16-12	3/4-14
10JG-16-16	1 5/16-12	1-11
10JG-16-20	1 5/16-12	1 1/4-11
10JG-16-24	1 5/16-12	1 1/2-11
10JG-20-16	1 7/8-12	1-11
10JG-20-20	1 7/8-12	1 1/4-11
10JG-24-16	1 7/8-12	1-11
10JG-24-20	1 7/8-12	1 1/4-11
10JG-24-24	1 7/8-12	1 1/2-11

## JIC Male to BSPPOR Male Adjustable 45° Elbow (Nut / Washer / O-Ring)

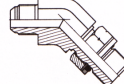
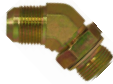

Part Number	JIC	BSPPOR
14JG-04-02	7/16-20	1/8-28
14JG-04-04	7/16-20	1/4-19
14JG-05-04	1/2-20	1/4-19
14JG-06-04	9/16-18	1/4-19
14JG-06-06	9/16-18	3/8-19
14JG-08-06	3/4-16	3/8-19
14JG-08-08	3/4-16	1/2-14
14JG-10-08	7/8-14	1/2-14
14JG-10-10	7/8-14	5/8-14
14JG-12-08	1 1/16-12	1/2-14
14JG-12-10	1 1/16-12	5/8-14
14JG-12-12	1 1/16-12	3/4-14
14JG-12-16	1 1/16-12	1-11
14JG-16-12	1 5/16-12	3/4-14
14JG-16-16	1 5/16-12	1-11
14JG-20-20	1 7/8-12	1 1/4-11
14JG-24-24	1 7/8-12	1 1/2-11

## JIC Male to BSPPOR Male Adjustable 90° Elbow (Nut / Washer / O-Ring)

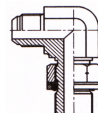

Part Number	JIC	BSPPOR
19JG-04-02	7/16-20	1/8-28
19JG-04-04	7/16-20	1/4-19
19JG-04-06	7/16-20	3/8-19
19JG-05-02	1/2-20	1/8-28
19JG-05-04	1/2-20	1/4-19
19JG-05-06	1/2-20	3/8-19
19JG-05-08	1/2-20	1/2-14
19JG-06-02	9/16-18	1/8-19
19JG-06-04	9/16-18	1/4-19
19JG-06-06	9/16-18	3/8-19
19JG-06-08	9/16-18	1/2-14
19JG-08-04	3/4-16	1/4-19

19JG series continued next column

19JG series continued from last column



Part Number	JIC	BSPPOR
19JG-08-06	3/4-16	3/8-19
19JG-08-08	3/4-16	1/2-14
19JG-08-10	3/4-16	5/8-14
19JG-08-12	3/4-16	3/4-14
19JG-10-04	7/8-14	1/4-19
19JG-10-06	7/8-14	3/8-19
19JG-10-08	7/8-14	1/2-14
19JG-10-10	7/8-14	5/8-14
19JG-10-12	7/8-14	3/4-14
19JG-12-08	1 1/16-12	1/2-14
19JG-12-12	1 1/16-12	3/4-14
19JG-12-16	1 1/16-12	1-11
19JG-16-12	1 5/16-12	3/4-14
19JG-16-16	1 5/16-12	1-11
19JG-16-20	1 5/16-12	1 1/4-11
19JG-20-16	1 7/8-12	1-11
19JG-20-20	1 7/8-12	1 1/4-11
19JG-24-16	1 7/8-12	1-11
19JG-24-20	1 7/8-12	1 1/4-11
19JG-24-24	1 7/8-12	1 1/2-11

## JIC Male to BSPPOR Male Adjustable Branch Tee (Nut / Washer / O-Ring)

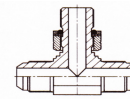

Part Number	JIC	JIC	BOR
AJJG-04-04-02	7/16-20	7/16-20	1/8-28
AJJG-04-04-04	7/16-20	7/16-20	1/4-19
AJJG-05-05-02	1/2-20	1/2-20	1/8-28
AJJG-05-05-04	1/2-20	1/2-20	1/4-19
AJJG-06-06-04	9/16-18	9/16-18	1/4-19
AJJG-06-06-06	9/16-18	9/16-18	3/8-19
AJJG-08-08-06	3/4-16	3/4-16	3/8-19
AJJG-08-08-08	3/4-16	3/4-16	1/2-14
AJJG-10-10-08	7/8-14	7/8-14	1/2-14
AJJG-12-12-12	1 1/16-12	1 1/16-12	3/4-14
AJJG-16-16-16	1 5/16-12	1 5/16-12	1-11

## JIC Male to BSPPOR Male Adjustable Run Tee (Nut / Washer / O-Ring)



Part Number	JIC	BOR	JIC
AJGJ-04-04-04	7/16-20	1/4-19	7/16-20
AJGJ-05-04-05	1/2-20	1/4-19	1/2-20
AJGJ-06-04-06	9/16-18	1/4-19	9/16-18
AJGJ-06-06-06	9/16-18	3/8-19	9/16-18
AJGJ-08-06-08	3/4-16	3/8-19	3/4-16
AJGJ-08-08-08	3/4-16	1/2-14	3/4-16
AJGJ-10-08-10	7/8-14	1/2-14	7/8-14
AJGJ-12-12-12	1 1/16-12	3/4-14	1 1/16-12
AJGJ-16-16-16	1 5/16-12	1-11	1 5/16-12

## BSPPOR Male to JIC Female Swivel

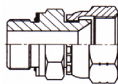

*This series quoted upon request.  
See 20BJ + BBS Bonded Seal for Equivalent*

Part Number	BSPPOR	JIC
20GJ-02-04	1/8-28	7/16-20
20GJ-04-04	1/4-19	7/16-20
20GJ-04-05	1/4-19	1/2-20
20GJ-04-06	1/4-19	9/16-18
20GJ-04-08	1/4-19	3/4-16
20GJ-06-06	3/8-19	9/16-18
20GJ-06-08	3/8-19	3/4-16
20GJ-08-06	1/2-14	9/16-18
20GJ-08-10	1/2-14	7/8-14
20GJ-12-08	3/4-14	3/4-16
20GJ-12-10	3/4-14	7/8-14
20GJ-12-12	3/4-14	1 1/16-12
20GJ-12-16	3/4-14	1 5/16-12
20GJ-16-16	1-11	1 5/16-12
20GJ-20-20	1 1/4-11	1 5/8-12
20GJ-24-24	1 1/2-11	1 7/8-12

## BSPPOR Male to Female JIC Swivel Adjustable 90° Elbow (Nut / Washer / O-Ring)

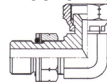

*This series quoted upon request.*

Part Number	BSPPOR	JIC
29GJ-04-04	1/4-19	7/16-20
29GJ-04-05	1/4-19	1/2-20
29GJ-04-06	1/4-19	9/16-18
29GJ-04-08	1/4-19	3/4-16
29GJ-06-06	3/8-19	9/16-18
29GJ-06-08	3/8-19	3/4-16
29GJ-08-06	1/2-14	9/16-18
29GJ-08-08	1/2-14	3/4-16
29GJ-08-10	1/2-14	7/8-14
29GJ-12-08	3/4-14	3/4-16
29GJ-12-10	3/4-14	7/8-14
29GJ-12-12	3/4-14	1 1/16-12
29GJ-16-16	1-11	1 5/16-12
29GJ-20-20	1 1/4-11	1 5/8-12
29GJ-24-24	1 1/2-11	1 7/8-12

## ORS Male to BSPPOR Male (Washer / O-Ring)

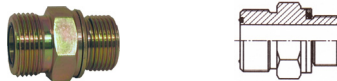

Part Number	ORS	BSPPOR
10FG-04-02	9/16-18	1/8-28
10FG-04-04	9/16-18	1/4-19
10FG-04-06	9/16-18	3/8-19
10FG-06-04	11/16-16	1/4-19
10FG-06-06	11/16-16	3/8-19
10FG-06-08	11/16-16	1/2-14
10FG-08-04	13/16-16	1/4-19
10FG-08-06	13/16-16	3/8-19
10FG-08-08	13/16-16	1/2-14
10FG-08-12	13/16-16	3/4-14
10FG-08-16	13/16-16	1-11
10FG-10-06	1-14	3/8-19
10FG-10-08	1-14	1/2-14
10FG-10-12	1-14	3/4-14
10FG-12-08	1 3/16-12	1/2-14

*10FG series continued next column*

10FG series continued from last column



Part Number	ORS	BSPPOR
10FG-12-12	1 3/16-12	3/4-14
10FG-12-16	1 3/16-12	1-11
10FG-16-12	1 7/16-12	3/4-14
10FG-16-16	1 7/16-12	1-11
10FG-20-16	1 11/16-12	1-11
10FG-20-20	1 11/16-12	1 1/4-11
10FG-24-24	2-12	1 1/2-11

## ORS Male to BSPPOR Male Adjustable 45° Elbow (Nut / Washer / O-Ring)



Part Number	ORS	BSPPOR
14FG-04-02	9/16-18	1/8-28
14FG-04-04	9/16-18	1/4-19
14FG-04-06	9/16-18	3/8-19
14FG-06-04	11/16-16	1/4-19
14FG-06-06	11/16-16	3/8-19
14FG-06-08	11/16-16	1/2-14
14FG-08-06	13/16-16	3/8-19
14FG-08-08	13/16-16	1/2-14
14FG-10-06	1-14	3/8-19
14FG-10-08	1-14	1/2-14
14FG-10-12	1-14	3/4-14
14FG-12-08	1 3/16-12	1/2-14
14FG-12-12	1 3/16-12	3/4-14
14FG-12-16	1 3/16-12	1-11
14FG-16-12	1 7/16-12	3/4-14
14FG-16-16	1 7/16-12	1-11
14FG-20-20	1 11/16-12	1 1/4-11

## ORS Male to BSPPOR Male Adjustable 90° Elbow (Nut / Washer / O-Ring)



Part Number	ORS	BSPPOR
<b>19FG-04-02</b>	9/16-18	1/8-28
<b>19FG-04-04</b>	9/16-18	1/4-19
<b>19FG-04-06</b>	9/16-18	3/8-19
<b>19FG-06-04</b>	11/16-16	1/4-19
<b>19FG-06-06</b>	11/16-16	3/8-19
<b>19FG-06-08</b>	11/16-16	1/2-14
<b>19FG-08-06</b>	13/16-16	3/8-19
<b>19FG-08-08</b>	13/16-16	1/2-14
<b>19FG-10-06</b>	1-14	3/8-19
<b>19FG-10-08</b>	1-14	1/2-14
<b>19FG-10-12</b>	1-14	3/4-14
<b>19FG-12-08</b>	13/16-12	1/2-14
<b>19FG-12-12</b>	13/16-12	3/4-14
<b>19FG-12-16</b>	13/16-12	1-11
<b>19FG-16-12</b>	17/16-12	3/4-14
<b>19FG-16-16</b>	17/16-12	1-11
<b>19FG-16-20</b>	17/16-12	1 1/4-11
<b>19FG-20-16</b>	1 11/16-12	1-11
<b>19FG-20-20</b>	1 11/16-12	1 1/4-11
<b>19FG-24-24</b>	2-12	1 1/2-11

## ORS Male to BSPPOR Male Adjustable Branch Tee (Nut / Washer / O-Ring)



Part Number	ORS	BOR	ORS
<b>AFGF-04-04-04</b>	9/16-20	1/4-19	9/16-20
<b>AFGF-04-06-04</b>	9/16-20	3/8-19	9/16-20
<b>AFGF-06-04-06</b>	11/16-20	1/4-19	11/16-20
<b>AFGF-06-06-06</b>	11/16-20	3/8-19	11/16-20
<b>AFGF-06-08-06</b>	11/16-20	1/2-14	11/16-20
<b>AFGF-08-06-08</b>	13/16-16	3/8-19	13/16-16
<b>AFGF-08-08-08</b>	13/16-16	1/2-14	13/16-16
<b>AFGF-08-12-08</b>	13/16-16	3/4-14	13/16-16
<b>AFGF-10-12-10</b>	1-14	3/4-14	1-14
<b>AFGF-10-16-10</b>	1-14	1-11	1-14
<b>AFGF-12-12-12</b>	13/16-12	3/4-14	13/16-12
<b>AFGF-12-16-12</b>	13/16-12	1-11	13/16-12
<b>AFGF-16-16-16</b>	17/16-12	1-11	17/16-12

## ORS Male to BSPPOR Male Adjustable Branch Tee (Nut / Washer / O-Ring)



Part Number	ORS	ORS	BOR
<b>AFFG-04-04-04</b>	9/16-20	9/16-20	1/4-19
<b>AFFG-04-04-06</b>	9/16-20	9/16-20	3/8-19
<b>AFFG-06-06-06</b>	11/16-20	11/16-20	3/8-19
<b>AFFG-06-06-08</b>	11/16-20	11/16-20	1/2-14
<b>AFFG-08-08-08</b>	13/16-16	13/16-16	1/2-14
<b>AFFG-08-08-12</b>	13/16-16	13/16-16	3/4-14
<b>AFFG-12-12-12</b>	13/16-12	13/16-12	3/4-14
<b>AFFG-12-12-16</b>	13/16-12	13/16-12	1-11
<b>AFFG-16-16-08</b>	17/16-12	17/16-12	1/2-14
<b>AFFG-16-16-12</b>	17/16-12	17/16-12	3/4-14
<b>AFFG-16-16-16</b>	17/16-12	17/16-12	1-11